

## BIFFI MORIN MANUAL OVERRIDE OPTIONS

A choice of manual overrides that allow operation of the actuator when supply pressure is not available. Each is available for both double-acting and spring-return actuators and their operation does not affect the travel stop setting.

### JACKSCREW – JSO

- Integral travel stop allows precise stroke adjustment of actuator operation.
- Standard handwheel may be removed to expose square drive for operation by wrench..
- Totally self-contained option.
- Eliminates the need for a declutch mechanism.

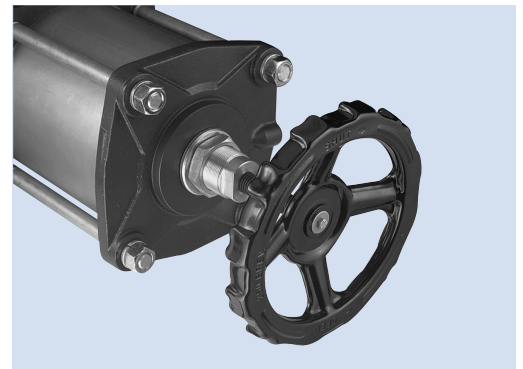

JACKSCREW JSO

### Hydraulic override – MHP

- Integral travel stop allows precise stroke adjustment of actuator operation.
- Integral control allows precise adjustment of automated package operating speed.
- Offers individual stroke speed control in both directions.
- Totally self-contained option.
- Enables manual operation of the largest actuators.

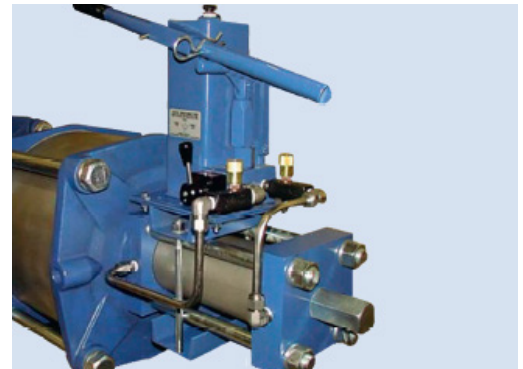

HYDRAULIC OVERRIDE - MHP

### Declutchable gear – D

- Large handwheel reduces effort required for operation.
- Installs between valve and actuator.
- Actuator's mounting interface is mirrored enabling all mounting hardware to fit declutch gearbox.

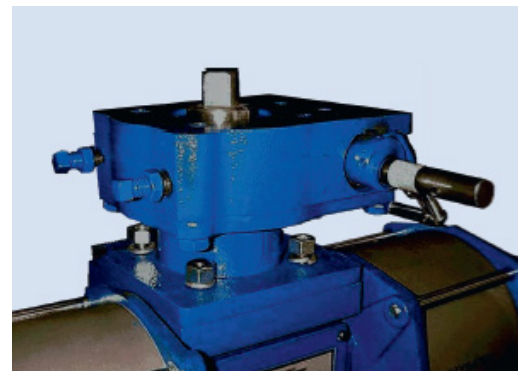

DECLUTCHABLE GEAR -D